

## Cross Roller Guide Model VR (VR4)

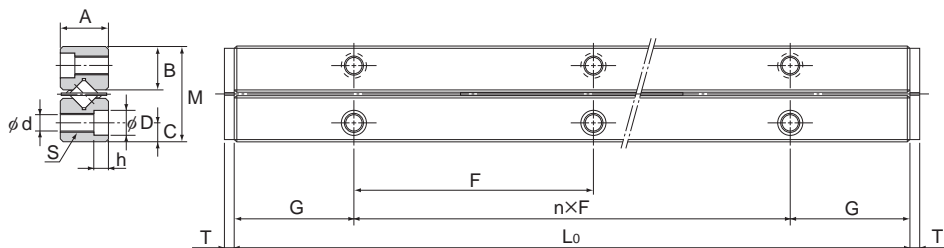

Model No.	Maximum stroke	Main								
		Combined dimensions			Mounting					
		M	A	L <sub>0</sub>	n×F	G	B	C	S	d
VR 4- 80×7Z	58	22	11	80	1×40	20	10.2	4.5	M5	4.3
VR 4-120×11Z	82			120	2×40					
VR 4-160×15Z	106			160	3×40					
VR 4-200×19Z	130			200	4×40					
VR 4-240×23Z	154			240	5×40					
VR 4-280×27Z	178			280	6×40					
VR 4-320×31Z	202			320	7×40					
VR 4-360×35Z	226			360	8×40					
VR 4-400×39Z	250			400	9×40					
VR 4-440×43Z	274			440	10×40					
VR 4-480×47Z	298			480	11×40					

### Model number coding

**VR4 -80 P × 9Z**

Number of rollers or balls

Accuracy symbol

Dedicated rail dimension in mm

(example of indication for a combination of different overall lengths: 120/160)

Combined model number (for Ball Guide: VB)

Note) "One set" in the model No. above indicates a combination of four rails and two cages.

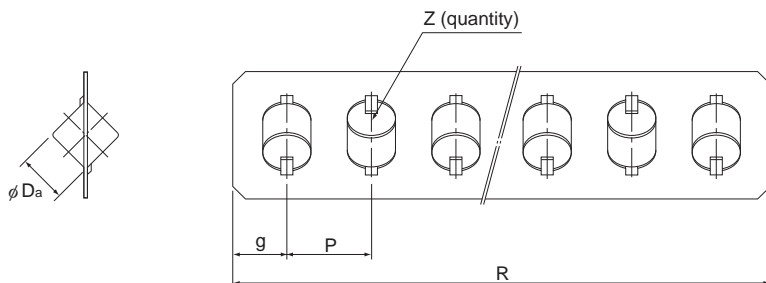

Unit: mm

dimensions								Permissible preload $\delta$ $\mu\text{m}$	Basic load rating (per roller)		Mass (rail) kg/m	
dimensions							No. of rollers Z		$C_z$ kN	$C_{0z}$ kN		
D	h	T	$D_a$	R	g	P						
8	4.2	2	4	51	4.5	7		7	-5	1.38	1.35	0.8
				79				11				
				107				15				
				135				19				
				163				23				
				191				27				
				219				31				
				247				35				
				275				39				
				303				43				
			331			47						

Note) When desiring a Ball Guide in combination with a ball cage, refer to **A7-26** on Ball Cage Model B and indicate the required number of balls.

(Example) VB4-200H x 17Z  
 └─── Number of balls

The mass in the table indicates the value per rail/m.

Stainless steel type with high corrosion resistance is also available. (symbol M, e.g., VR4M)