

Cross Roller Guide Model VR (VR1)

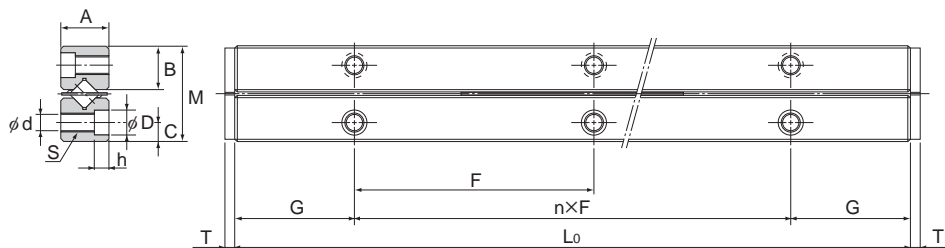

Model No.	Maximum stroke	Main								
		Combined dimensions			Mounting					
		M	A	L ₀	n×F	G	B	C	S	d
VR 1-20×5Z	12	8.5	4	20	1×10	5	3.9	1.8	M2	1.65
VR 1-30×7Z	22			30	2×10					
VR 1-40×10Z	27			40	3×10					
VR 1-50×13Z	32			50	4×10					
VR 1-60×16Z	37			60	5×10					
VR 1-70×19Z	42			70	6×10					
VR 1-80×21Z	52			80	7×10					

Model number coding

VR1 -30 H × 8Z

|
 | Accuracy symbol
 | Dedicated rail dimension in mm
 | (example of indication for a combination of different overall lengths: 40/50)
 | Combined model number (for Ball Guide: VB)

Note) "One set" in the model No. above indicates a combination of four rails and two cages.

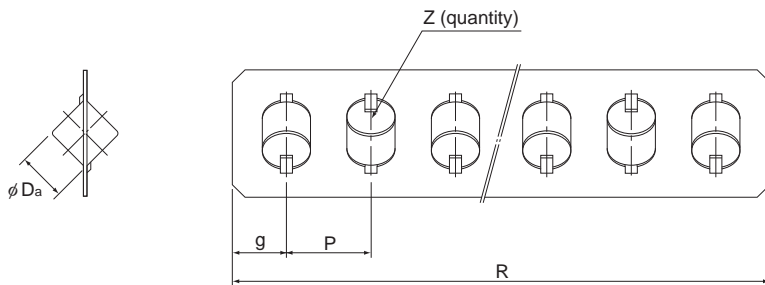

Unit: mm

dimensions								Permissible preload δ μm	Basic load rating (per roller)		Mass (rail) kg/m
dimensions									C_z kN	C_{oz} kN	
D	h	T	D_a	R	g	P	Z				
3	1.4	1.6	1.5	14	2	2.5	5	-2	0.152	0.153	0.11
				19			7				
				26.5			10				
				34			13				
				41.5			16				
				49			19				
				54			21				

Note) When desiring a Ball Guide in combination with a ball cage, refer to **A7-26** on Ball Cage Model B and indicate the required number of balls.

(Example) VB1-50H x $\overset{12Z}{\text{---}}$ Number of balls

The mass in the table indicates the value per rail/m.

Stainless steel type with high corrosion resistance is also available. (symbol M, e.g., VR1M)

To fix the dedicated rail of model VR1, use cross-recessed screws for precision equipment (No. 0 screw).

Model No.	Type	Nominal name of screw \times pitch
For model VR1	No. 0 pan-head screw (class 3)	M1.4 \times 0.3

Japan Camera Industry Association Standard JCIS 10-70
Cross-recessed screw for precision equipment (No. 0 screw)