

Model LM-MG (Stainless Steel Type)

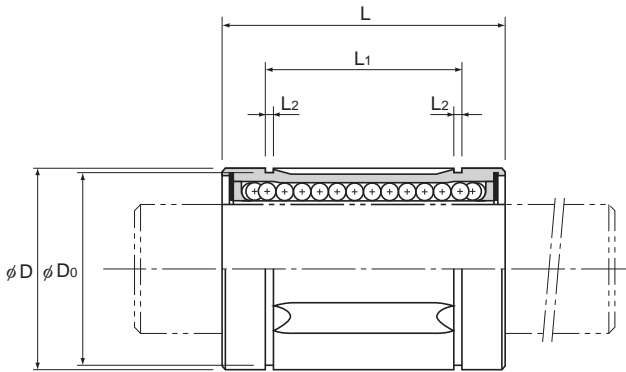

Model No.			Ball rows	Main						
Standard type	Clearance-adjustable type	Open type		Inscribed bore diameter		Outer diameter		Length		
				dr	Tolerance		D	Tolerance	L	Tolerance
				Precision	High	Precision/high	Precision/high			
LM 3M	—	—	4	3	0 -0.005	0 -0.008	7	0 -0.009	10	0 -0.12
LM 4M	—	—	4	4			8		12	
LM 5M	—	—	4	5			10		15	
* LM 6MG	LM 6MG-AJ	—	4	6	0 -0.006	0 -0.009	12	0 -0.011	19	0 -0.2
* LM 8SMG	LM 8SMG-AJ	—	4	8			15		17	
* LM 8MG	* LM 8MG-AJ	—	4	8			15		24	
* LM 10MG	* LM 10MG-AJ	—	4	10			19	29	0 -0.013	
* LM 12MG	* LM 12MG-AJ	—	4	12			21	30		
* LM 13MG	* LM 13MG-AJ	* LM13MGA-OP	4	13			23	32		
* LM 16MG	* LM 16MG-AJ	* LM16MGA-OP	4	16	28	37	0 -0.016			
* LM 20MG	* LM 20MG-AJ	* LM20MGA-OP	5	20	32	42				
* LM 25MG	* LM 25MG-AJ	* LM25MGA-OP	5	25	40	59		0 -0.3		
* LM 30MG	* LM 30MG-AJ	* LM30MGA-OP	6	30	45	64				
* LM 35MG	* LM 35MG-AJ	* LM35MGA-OP	6	35	52	70				
* LM 40MG	* LM 40MG-AJ	* LM40MGA-OP	6	40	60	80				

Note) Since this model contains a synthetic resin retainer, do not use it at temperature exceeding 80°C.

If the ambient temperature exceeds 80°C, use the type equipped with a metal retainer and indicate "A" at the end of the model number.

(For those marked with * in the table, metal retainers are available. Only metal retainer is available for open type.)

(Metal retainer types of models LM6MG, 8SMG and 8MG each have 3 rows of balls.)

(Example) LM30MG A

High temperature symbol

If requiring a type equipped with a seal, indicate it when placing an order. (seal heat resistance: 80°C.)

(Example) LM30MG UU

Seal attached on both ends of the nut

The accuracy of clearance-adjustable types (-AJ) and open types (-OP) in inscribed bore diameter and outer diameter indicates the value before division.

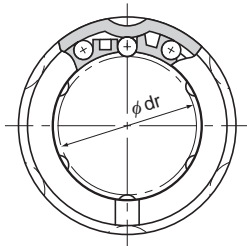

Model LM-MG

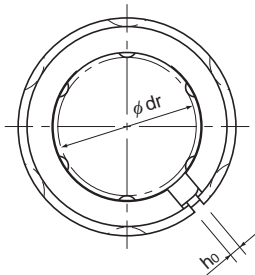

Model LM-MG-AJ

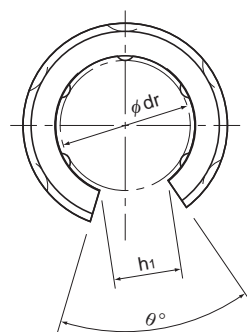

Model LM-MG-OP

Unit: mm

dimensions								Eccentricity (max) μm		Radial clearance tolerance μm	Basic load rating		
L_1	Tolerance	L_2	D_o	h_0	h_1	θ°	Precision	High	C N		C_0 N	Mass g	
—	—	—	—	—	—	—	4	8	-2	88.2	108	1.4	
—	—	—	—	—	—	—	4	8	-3	88.2	127	1.9	
10.2	-0.2	1.1	9.6	—	—	—	4	8	-3	167	206	4	
13.5		1.1	11.5	1	—	—	8	12	-5	206	265	8	
11.5		1.1	14.3	1	—	—	8	12	-5	176	225	11	
17.5		1.1	14.3	1	—	—	8	12	-5	265	402	16	
22		1.3	18	1	—	—	8	12	-5	373	549	30	
23		1.3	20	1.5	—	—	8	12	-5	412	598	31.5	
23		1.3	22	1.5	9	80	8	12	-7	510	775	43	
26.5		1.6	27	1.5	11	80	8	12	-7	775	1180	69	
30.5		1.6	30.5	1.5	11	60	10	15	-9	863	1370	87	
41		-0.3	1.85	38	2	12	50	10	15	-9	980	1570	220
44.5	1.85		43	2.5	15	50	10	15	-9	1570	2750	250	
49.5	2.1		49	2.5	17	50	12	20	-13	1670	3140	390	
60.5	2.1		57	3	20	50	12	20	-13	2160	4020	585	

Note) Since the nut and the balls use stainless steel, these models are highly resistant to corrosion and environment.
If oil holes are required, specify the model number with the OH symbol added to the end.

When using the Linear Bushing on a single shaft, use two or more bushings on the same shaft to minimize a moment load, and secure a large distance between the units.