

No Preload Type of Precision Ball Screw

Screw shaft outer diameter	50 to 55
Lead	10 to 100

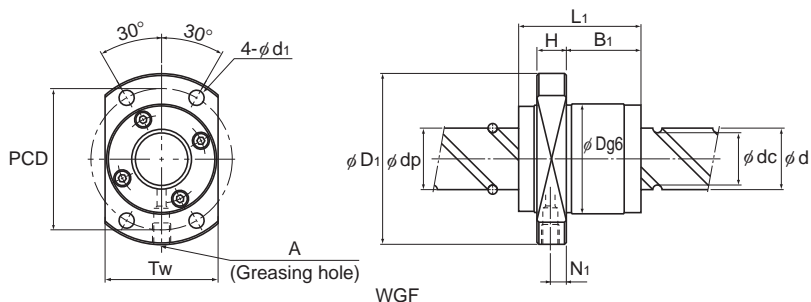

Screw shaft outer diameter d	Lead Ph	Model No.	Ball center-to-center diameter dp	Thread minor diameter dc	No. of loaded circuits Rows X turns	Basic load rating		Rigidity K N/μm	Outer diameter	
						Ca kN	C _{0a} kN		D	Flange diameter D ₁
						50	100	WGF 50100-1	52.2	44.1
		WGF 50100-3	52.2	44.1	2×1.65	49.9	127.2	650	90	135
55	10	BNF 5510-2.5	56.75	49.5	1×2.5	33.4	97	490	102	144
		BNF 5510-5	56.75	49.5	2×2.5	60.7	194	950	102	144
		BNF 5510-7.5	56.75	49.5	3×2.5	85.9	291.1	1390	102	144
	12	BNF 5512-2.5	57	49.2	1×2.5	39.3	108.8	500	105	147
		BNF 5512-3	57	49.2	2×1.5	46	131.3	590	105	147
		BNF 5512-3.5	57	49.2	1×3.5	52.4	152.9	680	105	147
		BNF 5512-5	57	49.2	2×2.5	71.3	218.5	960	105	147
		BNF 5512-7.5	57	49.2	3×2.5	100.9	327.3	1420	105	147
	16	BNF 5516-2.5	57.7	47.9	1×2.5	76.1	201.9	650	110	158
		BNF 5516-5	57.7	47.9	2×2.5	138.2	402.8	1280	110	158
	20	BNF 5520-2.5	57.7	47.9	1×2.5	76	201.9	660	112	158
		BNF 5520-5	57.7	47.9	2×2.5	138.2	403.8	1280	112	158

Note) The model numbers in dimmed type indicate semi-standard types. If desiring them, contact THK.
Model WGF cannot be attached with seal.

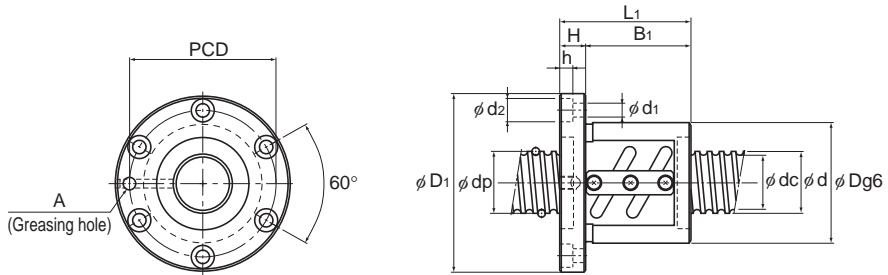

BNF

Unit: mm

Nut dimensions											Screw shaft inertial moment/mm ²	Nut mass	Shaft mass
Overall length	L ₁	H	B ₁	PCD	d ₁	d ₂	h	T _w	N _i	Greasing hole			
98	98	20	64	112	14	—	—	92	10	M6	4.82×10^{-2}	4.18	14.66
198	198	20	164	112	14	—	—	92	10	M6	4.82×10^{-2}	7.63	14.66
81	81	18	63	122	11	17.5	11	—	—	PT 1/8	7.05×10^{-2}	4.19	16.43
111	111	18	93	122	11	17.5	11	—	—	PT 1/8	7.05×10^{-2}	5.36	16.43
141	141	18	123	122	11	17.5	11	—	—	PT 1/8	7.05×10^{-2}	6.54	16.43
93	93	18	75	125	11	17.5	11	—	—	PT 1/8	7.05×10^{-2}	5.01	16.29
107	107	18	89	125	11	17.5	11	—	—	PT 1/8	7.05×10^{-2}	5.6	16.29
105	105	18	87	125	11	17.5	11	—	—	PT 1/8	7.05×10^{-2}	5.52	16.29
129	129	18	111	125	11	17.5	11	—	—	PT 1/8	7.05×10^{-2}	6.54	16.29
165	165	18	147	125	11	17.5	11	—	—	PT 1/8	7.05×10^{-2}	8.07	16.29
116	116	25	91	133	14	20	13	—	—	PT 1/8	7.05×10^{-2}	7.4	15.46
164	164	25	139	133	14	20	13	—	—	PT 1/8	7.05×10^{-2}	9.73	15.46
127	127	28	99	134	14	20	13	—	—	PT 1/8	7.05×10^{-2}	8.4	16.1
187	187	28	159	134	14	20	13	—	—	PT 1/8	7.05×10^{-2}	11.45	16.1

For model number coding, see **A15-248**.