

No Preload Type of Precision Ball Screw

Screw shaft outer diameter	32
Lead	4 to 12

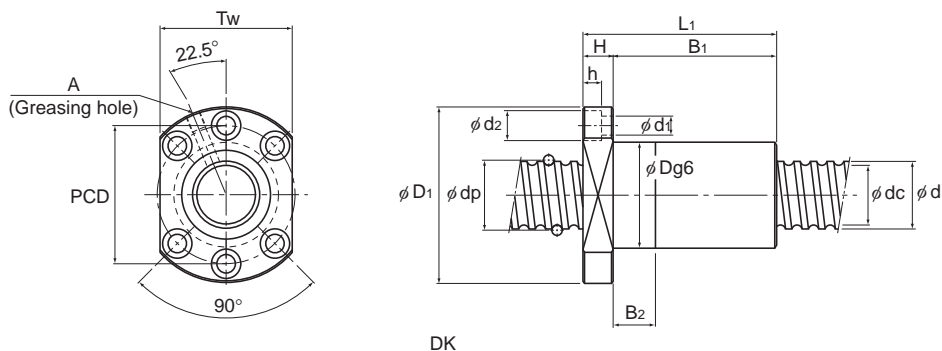

DK

Screw shaft outer diameter d	Lead Ph	Model No.	Ball center-to-center diameter dp	Thread minor diameter dc	No. of loaded circuits Rows X turns	Basic load rating		Rigidity K N/μm	Outer diameter D	Flange diameter D ₁
						Ca kN	C _{0a} kN			
32	4	BNF 3204-7.5	32.5	30	3×2.5	14.8	52.7	740	54	81
		DK 3204-3	32.5	30.1	3×1	6.4	19.6	290	45	76
		DK 3204-4	32.5	30.1	4×1	8.2	26.1	380	45	76
	5	○BNF 3205-2.5	32.75	29.2	1×2.5	10.2	28.1	280	58	85
		○BNF 3205-3	32.75	29.2	2×1.5	12	33.8	340	58	85
		○BNF 3205-4.5	32.75	29.2	3×1.5	17	50.7	500	58	85
		○BNF 3205-5	32.75	29.2	2×2.5	18.5	56.4	560	58	85
		○BNF 3205-7.5	32.75	29.2	3×2.5	26.3	84.5	810	58	85
		DK 3205-3	32.75	29.2	3×1	11.1	30.2	300	46	76
		DK 3205-4	32.75	29.2	4×1	14.2	40.3	400	46	76
	DK 3205-6	32.75	29.2	6×1	20.1	60.4	600	46	76	
	6	○BNF 3206-2.5	33	28.4	1×2.5	13.9	35.2	290	62	89
		○BNF 3206-3	33	28.4	2×1.5	16.3	42.2	350	62	89
		○BNF 3206-5	33	28.4	2×2.5	25.2	70.4	580	62	89
		DK 3206-3	33	28.4	3×1	14.9	37.1	310	48	76
		DK 3206-4	33	28.4	4×1	19.1	49.5	410	48	76
	8	○BNF 3208A-2.5	33.25	27.5	1×2.5	17.8	42.2	300	66	100
		○BNF 3208A-3	33.25	27.5	2×1.5	20.9	50.7	360	66	100
		○BNF 3208A-4.5	33.25	27.5	3×1.5	29.5	76	530	66	100
		○BNF 3208A-5	33.25	27.5	2×2.5	32.3	84.4	590	66	100
	10	○BNF 3210A-2.5	33.75	26.4	1×2.5	26.1	56.2	310	74	108
		○BNF 3210A-3	33.75	26.4	2×1.5	30.5	67.4	380	74	108
		○BNF 3210A-3.5	33.75	26.4	1×3.5	34.8	78.6	440	74	108
		○BNF 3210A-5	33.75	26.4	2×2.5	47.2	112.7	620	74	108
		DK 3210-3	33.75	26.4	3×1	25.7	52.2	300	54	87
		DK 3210-4	33.75	26.4	4×1	33	69.7	390	54	87
	12	○BNF 3212-3.5	34	26.1	1×3.5	40.4	88.5	440	76	121
		DK 3212-4	33.75	26.4	4×1	34.2	73.9	420	54	87

Note) The model numbers in dimmed type indicate semi-standard types. If desiring them, contact THK.
Those models marked with ○ can be attached with QZ Lubricator or the wiper ring.
For dimensions of the ball screw nut with either accessory being attached, see **A15-356**.

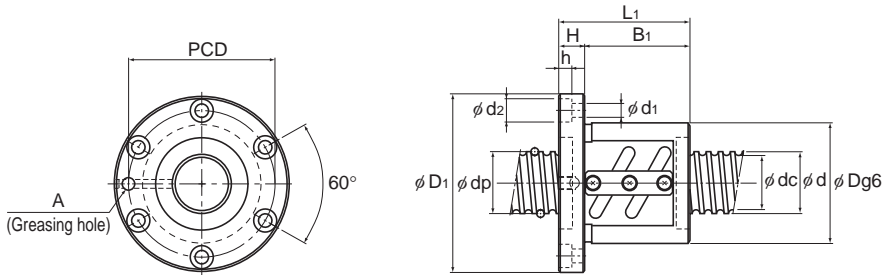

BNF

Unit: mm

Nut dimensions											Screw shaft inertial moment/mm ³	Nut mass	Shaft mass
Overall length	H	B ₁	B ₂	PCD	d ₁	d ₂	h	Tw	Greasing hole	kg·cm ² /mm			
L ₁									A				
60	11	49	—	67	6.6	11	6.5	—	M6	8.08 × 10 ⁻³	0.81	5.86	
44	11	33	10	63	6.6	11	6.5	59	M6	8.08 × 10 ⁻³	0.44	5.86	
48	11	37	10	63	6.6	11	6.5	59	M6	8.08 × 10 ⁻³	0.47	5.86	
41	12	29	—	71	6.6	11	6.5	—	M6	8.08 × 10 ⁻³	0.76	5.67	
53	12	41	—	71	6.6	11	6.5	—	M6	8.08 × 10 ⁻³	0.91	5.67	
63	12	51	—	71	6.6	11	6.5	—	M6	8.08 × 10 ⁻³	1.03	5.67	
56	12	44	—	71	6.6	11	6.5	—	M6	8.08 × 10 ⁻³	0.94	5.67	
71	12	59	—	71	6.6	11	6.5	—	M6	8.08 × 10 ⁻³	1.13	5.67	
47	12	35	10	63	6.6	11	6.5	59	M6	8.08 × 10 ⁻³	0.5	5.67	
52	12	40	10	63	6.6	11	6.5	59	M6	8.08 × 10 ⁻³	0.53	5.67	
62	12	50	10	63	6.6	11	6.5	59	M6	8.08 × 10 ⁻³	0.6	5.67	
45	12	33	—	75	6.6	11	6.5	—	M6	8.08 × 10 ⁻³	0.94	5.47	
57	12	45	—	75	6.6	11	6.5	—	M6	8.08 × 10 ⁻³	1.12	5.47	
63	12	51	—	75	6.6	11	6.5	—	M6	8.08 × 10 ⁻³	1.21	5.47	
53	12	41	10	63	6.6	11	6.5	59	M6	8.08 × 10 ⁻³	0.58	6.31	
61	12	49	10	63	6.6	11	6.5	59	M6	8.08 × 10 ⁻³	0.65	6.31	
58	15	43	—	82	9	14	8.5	—	M6	8.08 × 10 ⁻³	1.5	5.39	
71	15	56	—	82	9	14	8.5	—	M6	8.08 × 10 ⁻³	1.73	5.39	
87	15	72	—	82	9	14	8.5	—	M6	8.08 × 10 ⁻³	2.02	5.39	
82	15	67	—	82	9	14	8.5	—	M6	8.08 × 10 ⁻³	1.93	5.39	
70	15	55	—	90	9	14	8.5	—	M6	8.08 × 10 ⁻³	2.2	4.98	
87	15	72	—	90	9	14	8.5	—	M6	8.08 × 10 ⁻³	2.6	4.98	
80	15	65	—	90	9	14	8.5	—	M6	8.08 × 10 ⁻³	2.44	4.98	
100	15	85	—	90	9	14	8.5	—	M6	8.08 × 10 ⁻³	2.92	4.98	
80	15	65	15	69	9	14	8.5	66	M6	8.08 × 10 ⁻³	1.22	4.98	
90	15	75	20	69	9	14	8.5	66	M6	8.08 × 10 ⁻³	1.34	4.98	
98	18	80	—	98	11	17.5	11	—	M6	8.08 × 10 ⁻³	3.4	4.9	
98	15	83	25	69	9	14	8.5	66	M6	8.08 × 10 ⁻³	1.43	5.2	

For model number coding, see **A15-248**.