

Preload Type of Precision Ball Screw

Screw shaft outer diameter	28
Lead	5 to 10

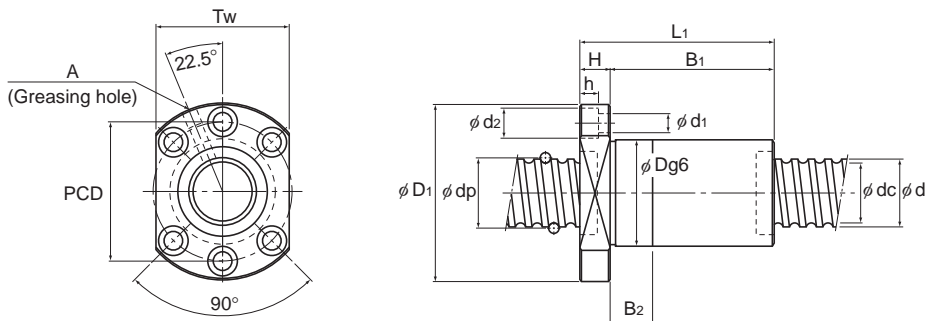

DIK (2805 to 6312)

Screw shaft outer diameter d	Lead Ph	Model No.	Ball center-to-center diameter dp	Thread minor diameter dc	No. of loaded circuits Rows X turns	Basic load rating		Rigidity K N/μm
						Ca kN	C _{0a} kN	
28	5	BIF 2805-5	28.75	25.2	1×2.5	9.7	24.6	520
		BIF 2805-6	28.75	25.2	2×1.5	11.3	29.5	620
		BIF 2805-7	28.75	25.2	1×3.5	12.9	34.4	720
		BIF 2805-10	28.75	25.2	2×2.5	17.4	49.4	1000
		DIK 2805-6	28.75	25.2	3×1	10.5	26.4	560
		DIK 2805-8	28.75	25.2	4×1	13.4	35.2	730
	6	BNFN 2805-7.5	28.75	25.2	3×2.5	24.8	73.8	1470
		BIF 2806-5	28.75	25.2	1×2.5	9.6	24.6	520
		BIF 2806-7	28.75	25.2	1×3.5	12.9	34.5	710
		BIF 2806-10	28.75	25.2	2×2.5	17.5	49.4	1000
		DIK 2806-6	29	24.4	3×1	14	32	530
		BNFN 2806-7.5	28.75	25.2	3×2.5	24.8	73.8	1470
	8	BIF 2808-5	29.25	23.6	1×2.5	16.8	36.8	550
		BIF 2808-6	29.25	23.6	2×1.5	19.6	44.2	660
		BIF 2808-10	29.25	23.6	2×2.5	30.4	73.7	1060
	10	BIF 2810-3	29.75	22.4	1×1.5	15.7	29.4	350
		DIK 2810-4	29.25	23.6	2×1	12.3	25	380
		BNFN 2810-2.5	29.75	22.4	1×2.5	24	48.2	560

Note) The model numbers in dimmed type indicate semi-standard types.
If desiring them, contact THK.

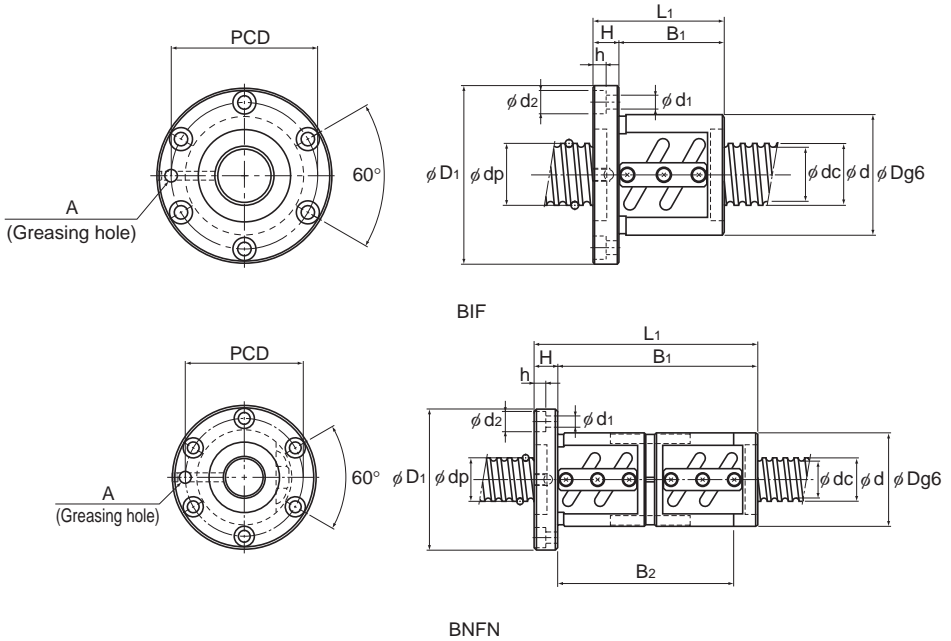

Unit: mm

	Nut dimensions										Screw shaft inertial moment/mm ³	Nut mass	Shaft mass
	Outer diameter	Flange diameter	Overall length	H	B ₁	B ₂	PCD	d ₁ × d ₂ × h	Tw	Greasing hole			
	D	D _f	L ₁	H	B ₁	B ₂	PCD	d ₁ × d ₂ × h	Tw	A	kg·cm ² /mm ³	kg	kg/m
	55	85	59	12	47	—	69	6.6 × 11 × 6.5	—	M6	4.74 × 10 ⁻³	0.98	4.27
	55	85	79	12	67	69	69	6.6 × 11 × 6.5	—	M6	4.74 × 10 ⁻³	1.27	4.27
	55	85	69	12	57	59	69	6.6 × 11 × 6.5	—	M6	4.74 × 10 ⁻³	1.14	4.27
	55	85	89	12	77	—	69	6.6 × 11 × 6.5	—	M6	4.74 × 10 ⁻³	1.34	4.27
	43	71	69	12	57	15	57	6.6 × 11 × 6.5	55	M6	4.74 × 10 ⁻³	0.61	4.27
	43	71	79	12	67	20	57	6.6 × 11 × 6.5	55	M6	4.74 × 10 ⁻³	0.68	4.27
	55	85	134	12	122	109	69	6.6 × 11 × 6.5	—	M6	4.74 × 10 ⁻³	1.88	4.27
	55	85	68	12	56	—	69	6.6 × 11 × 6.5	—	M6	4.74 × 10 ⁻³	1.09	4.36
	55	85	80	12	68	73	69	6.6 × 11 × 6.5	—	M6	4.74 × 10 ⁻³	1.27	4.36
	55	85	104	12	92	—	69	6.6 × 11 × 6.5	—	M6	4.74 × 10 ⁻³	1.52	4.36
	43	71	73	12	61	15	57	6.6 × 11 × 6.5	55	M6	4.74 × 10 ⁻³	0.64	4.36
	55	85	158	12	146	133	69	6.6 × 11 × 6.5	—	M6	4.74 × 10 ⁻³	2.16	4.36
	60	104	92	18	74	—	82	11 × 17.5 × 11	—	M6	4.74 × 10 ⁻³	2.11	4.02
	60	104	120	18	102	—	82	11 × 17.5 × 11	—	M6	4.74 × 10 ⁻³	2.45	4.02
	60	104	140	18	122	—	82	11 × 17.5 × 11	—	M6	4.74 × 10 ⁻³	2.74	4.02
	65	106	88	18	70	—	85	11 × 17.5 × 11	—	M6	4.74 × 10 ⁻³	2.33	3.66
	45	71	84	15	69	20	57	6.6 × 11 × 6.5	55	M6	4.74 × 10 ⁻³	0.82	4.18
	65	106	146	18	128	—	85	11 × 17.5 × 11	—	M6	4.74 × 10 ⁻³	3.41	3.66

For model number coding, see [A15-248](#).